

{ RESIDENTIAL FLAGPOLES }

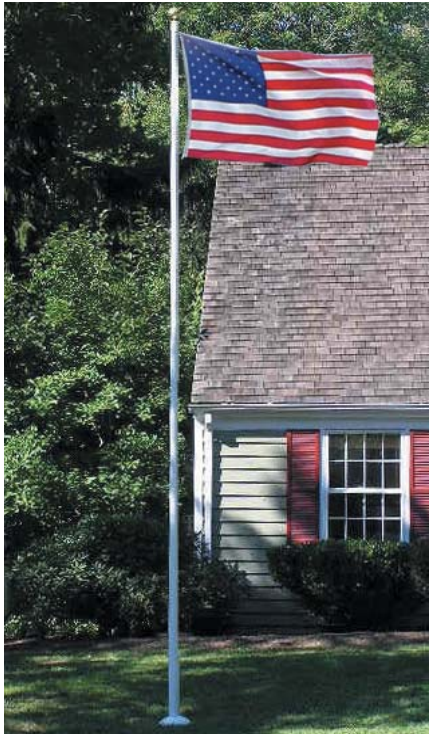

THE VILLAGER III ALLIANCE RESIDENTIAL FLAGPOLE

- Sectional 20 ft. Fiberglass Pole
- Easy- to- Assemble Sections
- Features all of the Strength and Beauty of Our One-Piece Alliance Flagpoles but Lighter in Weight and UPS Ship-able*.
*Ships at Oversize Rate
- Maintenance-free white gel-coat finish looks brand new after years of use.
- Beautiful tapered design compliments any type of architecture.
- Exceptional strength designed to withstand wind speeds in excess of 100mph (un-flagged), Tensile strength is 50,000 lbs. per square inch.

Item # Style No./Sec. Butt Dia. Top Dia. Weight
395 FG20-3PC 3 3 3/4" 2" 27 lbs.



STYLE S – STEEL POLE NOT SHOWN

A truly outstanding value! Galvanized steel pole with white powder coated finish. Easily erected and dismantled. Complete with gold vinyl ball ornament, aluminum pulley, cleat, halyard and ground socket. Directions for easy installation included.

Item # Style Ht. No./Sec. Butt Dia. Top Dia. Weight
741100 18SP 18' 3 1 3/4" 1 1/2" 17 lbs.

MULTI-USE TELESCOPING POLE YOU'LL NEVER NEED ANOTHER FLAGPOLE

- Four Aluminum Telescoping Sections
- Snap-Lock Sections for Full Extension
- Or Twist Lock to Adjustable Height
- In-Ground or Tire Mount
- Fly Traditional Flag on Pole
- Or Display Banner on Rotating Arm



INCLUDES ALL ACCESSORIES NEEDED TO DISPLAY FLAG OR BANNER

- Wheel Stand
- Ground Sleeve
- 3 ft. Rotating Arm for Banner Display
- Gold Aluminum Ball

Item #648

GREAT FOR...

- Tailgating
- Residential Display
- Special Events
- Advertising

Specifications

- Adjustable up to 19 feet
- 2 in. base diameter- 1 3/8 in. top diameter
- 14 in. PVC ground socket

Note: Do not use with motor homes. Use with vehicles only.
Aluminum Sand Sleeve- Item# 1154-(Not Shown)



Note: Earth Banner sold on page 20.

US FLAGS & SETS
STATE FLAGS
SMALL FLAGS & DESK SETS
MARINE FLAGS
INTERNATIONAL FLAGS
CUSTOM FLAGS
DECORATIONS
HARDWARE & SMALL POLES



IN GROUND POLES

{ ALUMINUM FLAGPOLES }

As a leader in the industry for over 160 years, Annin & Co. continues to offer a wide variety of aluminum flagpoles for virtually every application.

STYLE AA3 20-FT. ALUMINUM CONE-TAPERED POLE

- Ideal for Industrial, School or Residential Use!

A truly outstanding value! Comes in two sections, each 11' long which join to form a 20' (above ground) tapered aluminum pole with brushed finish. Supplied complete with gold anodized aluminum ball and all accessories. Pole tapers from 3" at butt to 2" at top. Packaged complete in corrugated carton. Easy to install.

Item #	Style	Weight
745325	AA3	41 lbs.

LARGE OUTDOOR POLES

Cone-Tapered Aluminum Flagpoles

- AD-20, AD-25 & AD-30 Poles Shipped with Gold Anodized Ball, Stationary Truck, Flash Collar, Polypropylene Halyard, 2 Nylon Snaps, 9" Cleat and Plastic Ground Tube.
- All other Poles Supplied with Gold Anodized Ball, Flash Collar, Polypropylene Halyard, 2 Bronze Swivel Snaps, 9" Cleat, Galvanized Steel Corrugated Ground Socket with Attached Lightning Strike.
- Internal Halyards May be Added at Extra Cost. Check with Your Dealer.
- Rich, Natural Satin Finish.
- Includes all Accessories for Complete Installation Except Flag.
- H Models have Increased Butt Diameter, Taper and Revolving Truck.

One or Two Halyard Item #	Style	Height Above Ground	Ground Socket Length	Butt. Dia.	Top Dia.	Ball Dia.	Wall Thickness	Gross Weight Lbs.
743155	AD-20	20'	2'	3"	17/8"	3"	.125"	50
743150	ADH-20	20'	2'	4"	27/8"	4"	.125"	77
743255	AD-25	25'	2 1/2'	3"	17/8"	3"	.125"	66
746101	ADH-25	25'	2 1/2'	5"	3"	5"	.125"	134
743355	AD-30	30'	3'	4"	2 1/2"	5"	.125"	104
746201	ADH-30	30'	3'	5"	3"	5"	.125"	143
743450	AD-35	35'	3 1/2'	5"	3"	5"	.156"	242
746301	ADH-35	35'	3 1/2'	6"	3 1/2"	6"	.156"	261
746401	ADH-40	40'	4'	7"	3 1/2"	8"	.188"	317

Larger sizes priced upon application

Due to carrier limitations, commercial poles 25' and larger may be shipped in two sections.

DID YOU KNOW?

Once you receive an aluminum flagpole it should immediately be removed from the container and unwrapped to prevent staining.



US FLAGS & SETS
STATE FLAGS
SMALL FLAGS & DESK SETS
MARINE FLAGS
INTERNATIONAL FLAGS
CUSTOM FLAGS
DECORATIONS
HARDWARE & SMALL POLES

IN GROUND POLES

{ OUTDOOR FLAGPOLE ACCESSORIES }



Made in USA

BANNER CLIPS

- Anchor Banners and Flags the Easy Way with re-usable Banner Clips.
- Available in two sizes these easy-to-use clips eliminate the need for grommets.
- The heavier the load, the tighter the grip.



Small
1 1/2 X 1 1/4 inch
Item # 913

Medium
1 3/4 X 1 1/2 inch
Item # 912

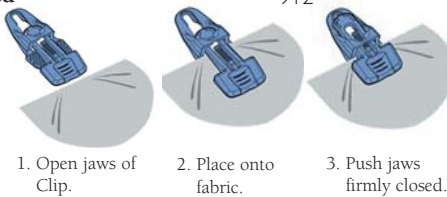

SUPER SNAPS

- Easy On-Easy Off
- Mounting eye fits halyard 1/8 inch to 3/8 inch
- Suitable for flag sizes 2 X 3 ft. up through 6X10 ft.
- Silent, Strong, Safe & Economical
- Will not mar or scratch your Flagpole

Item # 914



Made in USA

Outdoor Aluminum Eagles

At last, an inexpensive flying eagle on spindle (no ball) appropriate for poles 20-35 feet in height. Tough aluminum casting with durable gold finish.

Item #	Style	WingSpan	Total Height	Dia. of Spindle
801696	3F	16"	18 in.	1/2"
601750	9F	9"		1/2"
601700	Patriot	8 1/2"	10 in.	1/2"

Aluminum Trucks

Fit all Annin cone-tapered aluminum and fiberglass poles. Cast of strong tenzalo aluminum alloy and equipped with two machine-turned aluminum sheaves. Drilled and tapped for balls and eagles with 1/2" dia. spindle. Styles 2S-R and 2S-HR are revolving trucks which rotate freely on 22 stainless steel ball bearings.

Item #	Style	Dia.	Sheaves	Bore	*Tapped for 5/8" Ball Spindle
807601	2S (sta.)	5 1/2"	2	1 5/8"	
807603	*2S-HR (rev.)	8"	2	1 5/8"	

Outrigger Style Truck

Cast of strong tenzalo aluminum alloy, and designed especially for use with Annin outrigger poles. (Fits balls with 1/2" spindle.)

Item # 807604 Style OR-1 Bore 2 3/8"

Light Duty Truck

This small but dependable cast aluminum truck is designed for light-duty poles. Fits over 1 1/4" O.D. poles (Lexington), or into 1 3/8" I.D. poles. Equipped with one cast aluminum sheave and drilled to accept our 4" ball with 1/2" dia. spindle.

Item # 807605 Style 1 SL Size 3"

Replacement Truck for Patriot Pole

Single sheave, 2" inside diameter. Drilled to accept 1/2" diameter spindle.

Item # 807606 Style 2 SL Dia. 2"

Aluminum and Nylon Cleats

Style A-9 cast of strong tenzalo aluminum alloy – Styles N-6 and N-8 are molded nylon. (white only).

Item #	Style/Type	Size
802572	A-9/aluminum	9"
802573	N-6/nylon	6"

Aluminum Balls

Heavy-gauge flush-seam aluminum ball with long lasting gold anodized finish. Mounted on heavy threaded aluminum spindle.

Item #	Size	Rod Size
800049	3"	1/2"
800053	4"	1/2"
800050	5"	1/2"
800051	6"	1/2"
800052	8"	1/2"
800057	10"	5/8"

Non-Tangle Rods

Prevents flag from wrapping around outrigger style poles. Stainless steel rod with vinyl clamps.

Item #	Length	For Flag Size
806800	2 1/2'	3 x 5' — 4 x 6'
806802	4'	5 x 8' — 6 x 10'
806806	7'	8 x 12 & larger

Snap Hooks Brass – U.S. Govt. "Type 1" brass swivel snaps 802710

Nylon – One-piece molded nylon. Quiet, non-marking. Defies the elements. 802720

Nylon Halyards

803502 3/16" diameter per foot	803504 1/4" diameter per foot
803503 5/16" diameter per foot	803505 3/8" diameter per foot
1008576 1/4" wire core Halyard per foot	

US FLAGS & SETS

STATE FLAGS

SMALL FLAGS & DESK SETS

MARINE FLAGS

INTERNATIONAL FLAGS

CUSTOM FLAGS

DECORATIONS

HARDWARE & SMALL POLES

IN GROUND POLES

{ ANNIN ALLIANCE FIBERGLASS FLAGPOLES }

AN ALLIANCE OF STRENGTH AND BEAUTY

US FLAGS & SETS

STATE FLAGS

SMALL FLAGS & DESK SETS

MARINE FLAGS

INTERNATIONAL FLAGS

CUSTOM FLAGS

DECORATIONS

HARDWARE & SMALL POLES

IN GROUND POLES



- New Gel-Coat Surface won't Soil, Scratch, Chalk Crackle or Mildew Over Time
- Maintenance Free, Safe and Strong
- Graceful Entasis Taper
- Simple Low Cost Ground Sleeve Installation
- Your Choice of Internal or External Models

Flagpole Size	Recommended Flag Size	Wind Speed Flagged*	Wind Speed Un-Flagged
20ft	3x5 ft.	100mph	130 mph
25ft	4x6 ft.	100mph	130 mph
30ft	5x8 ft.	100mph	130 mph
35ft	6x10 ft.	100mph	130 mph
40ft	8x12 ft.	100mph	130 mph

*While the poles are designed to withstand winds up to 100 MPH flying the flag sizes indicated, we strongly recommend that the flags be lowered when winds exceed 50 MPH to avoid damage to the flags.

The above information on maximum wind speeds is provided based on the poles being correctly installed and flying only one flag that does not exceed the recommended size for that pole.

Accessories cannot be guaranteed separately as they may be subject to improper use.



It still looks new!
This pole with Polymer Gel-Coat finish has been exposed to the elements for 10 years.

{ ANNIN'S EXCLUSIVE ALLIANCE FIBERGLASS FLAGPOLES }

SUPERIOR STRUCTURE • GRACEFUL TAPER • GLEAMING WHITE FINISH



- 50,000 pounds per square inch tensile strength
Manufactured with Pressure Molding method these poles have a higher glass content and maximum strength.
- Rated to withstand wind speeds of up to 130 miles per hour unflagged
Designed to withstand Maximum wind speeds of 100 mph when correctly installed and with recommended flag size.
- Precision made maintenance free rotating truck included
360° Tangle Free flying in all wind conditions
- Polymer Gel-Coat finish provides Maintenance-Free Longevity
Won't crackle, soil, discolor, chalk, scratch or mildew over time
- These poles are supplied complete with anodized gold ball, base cover, ground sleeve and all accessories needed for installation.
A variety of alternative finials and custom colors available by special order



External Ground-Set

Item Number	Name	Number of Sections	Above Ground Height	Butt Diameter	Top Diameter	Shaft Weight in lbs.	Shipping Weight in lbs.	Ball Diameter	Ground Sleeve
46	FG 20	1	20 ft	4 ³ / ₄ in	3 in	30	48	5 in	2 ft x 5 ¹ / ₂ in
397	FG 245R	1	25 ft*	4 ³ / ₄ in	3 in	34	63	5 in	3 ft x 5 ¹ / ₂ in
396	FG 245C	1	25 ft*	6 in	3 in	38	74	6 in	3 ft x 7 in
407	FG 30	2	30 ft	6 ³ / ₄ in	3 in	74	120	6 in	3 ft x 8 in
409	FG 35	2	35 ft	7 in	3 in	88	153	6 in	4 ft x 8 in
411	FG 40	2	40 ft	7 in	3 in	110	204	6 in	4 ft x 8 in

External Tilt Base **

177	FG 35	1	35 ft	7 in	3 in	134	180	6 in	11 in x 11 in
153	FG 40	1	40 ft	7 in	3 in	156	221	6 in	11 in x 11 in

Internal Ground-Set

Item Number	Name	Number of Sections	Above Ground Height	Butt Diameter	Top Diameter	Shaft Weight in lbs.	Shipping Weight in lbs.	Ball Diameter	Ground Sleeve
399	FGI 245	1	25 ft*	6 in	3 in	38	74	6 in	3 ft x 5 ¹ / ₂ in
406	FGI 30	2	30 ft	6 ³ / ₄ in	3 in	74	120	6 in	3 ft x 8 in
408	FGI 35	2	35 ft	7 in	3 in	88	153	6 in	4 ft x 8 in
410	FGI 40	2	40 ft	7 in	3 in	110	204	6 in	4 ft x 8 in

Internal Tilt Base **

175	FGI 35	1	35 ft	7 in	3 in	134	180	6 in	11 in x 11 in
154	FGI 40	1	40 ft	7 in	3 in	156	221	6 in	11 in x 11 in

*Nominal Height ** To Be Discontinued - Supplies Limited

FIBERGLASS YARDARMS FOR ALLIANCE FLAGPOLES

Beautifully tapered, lightweight, easy to install and featuring the same gel-coat finish that keeps our flagpoles looking new for years.

Item#	Description	Shipping Weight in lbs.
171	Yardarms for 25C Poles	23
170	Yardarms for 30ft. Poles	28
172	Yardarms for 35ft. & 40 ft. Poles	34



Internal halyard assembly discourages vandalism.

Note: All poles are manufactured with a verticle seam approx. 1/8" diameter.

US FLAGS & SETS

STATE FLAGS

SMALL FLAGS & DESK SETS

MARINE FLAGS

INTERNATIONAL FLAGS

CUSTOM FLAGS

DECORATIONS

HARDWARE & SMALL POLES

IN GROUND POLES